

SOHO CHAMPAGNE II

SUITE 05 THE PERRIER-JOUËT - 635 SQ.FT.

635 SQ.FT. SUITE
1 BEDROOM + DEN

4th-23rd Floor

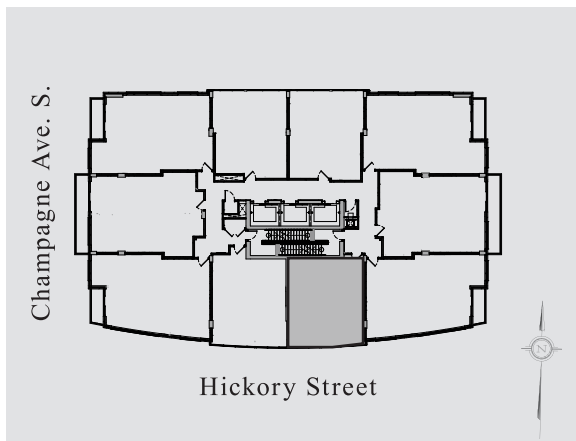
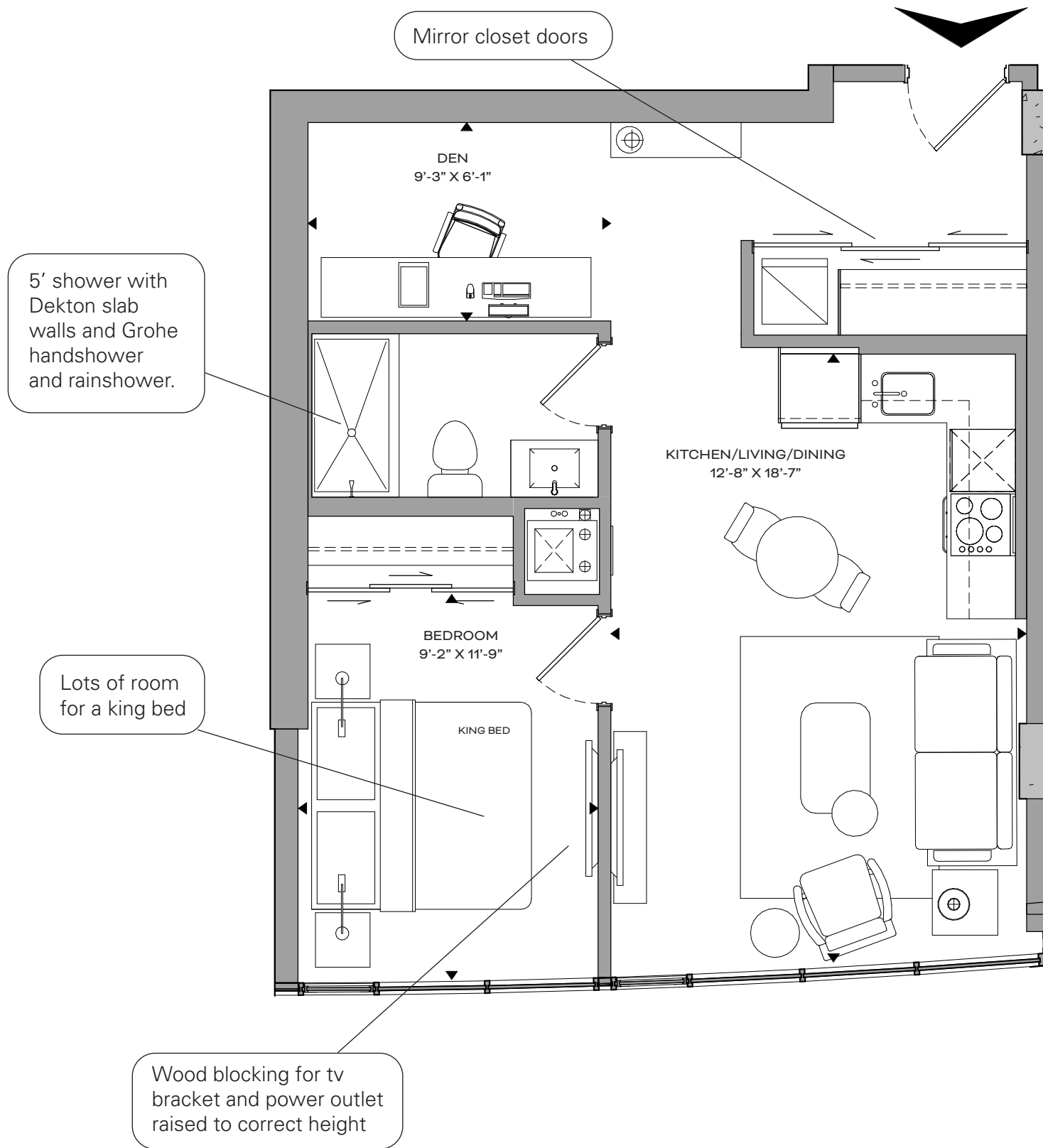

MADE IN ITALY KITCHEN

- UNDER COUNTER VALANCE LIGHTING
- DRYWALL CEILING IN BEDROOMS WITH POTLIGHTS
- FLOOR-TO-CEILING WINDOWS
- CONCRETE CEILINGS IN LIVING AREAS
- DEKTON TO 42" ON VANITY WALL
- GROHE RAINSHOWER HEAD AND HANDSHOWER
- GROHE ACCESSORIES IN BATHROOM
- KOHLER MEDICINE CABINET

WOOD BLOCKING FOR TV BRACKET IN BEDROOMS AND POWER AT CORRECT HEIGHT.

- WHIRLPOOL ENERGY STAR APPLIANCES, INCLUDING INTEGRATED DISHWASHER, COOKTOP AND WALL OVEN, LG 28" STAINLESS STEEL FRIDGE, AND WASHER/DRYER.
- CLOSET ORGANIZER WITH DRAWERS AND SHELVES
- MIRROR SLIDING CLOSET DOORS
- DEKTON SLAB STONE SHOWER WALLS
- ENERGY SAVING BLACK OUT BLINDS AND SHEAR WEAVE
- BELL FIBRE TO EACH SOHO APARTMENT

GLUCKSTEINDESIGN

MICHAEL
LONDON
DESIGN

MASTERCRAFT STARWOOD
Investment Builders Since 1951

KOHLER

DEKTON

GROHE
ENJOY WATER

Dimensions, specifications, layouts and materials are approximate only and are subject to change without notice. Window sizes and locations may vary. Actual usable floor space within the unit may be different from stated floor areas or dimensions on this plan. Suite, balcony and terrace area calculated by the building architects RLA. E&O.E. July 2023